

Skier Sunray 260 DT User Manual

Package Contents

Sunray 260 DT x 1
LED COB Protector (Installed) x 1
Quick release Light stand joint x 1
19.68 feet Power Cable x 1
Power Supplier x 1
Hanging bag for Power Supplier x 1

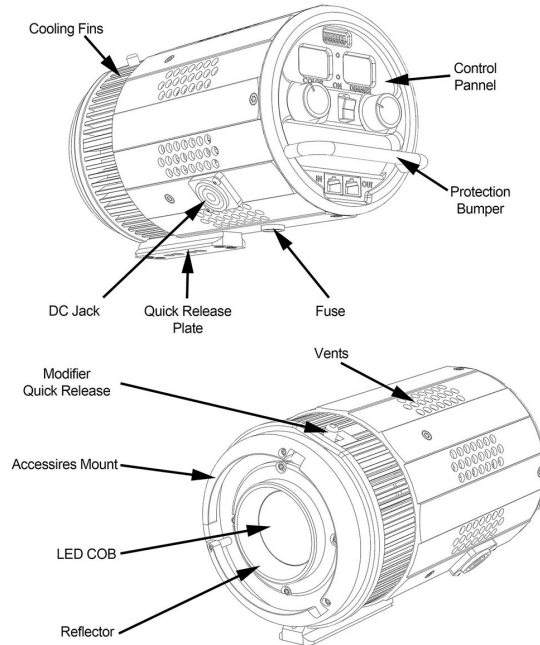
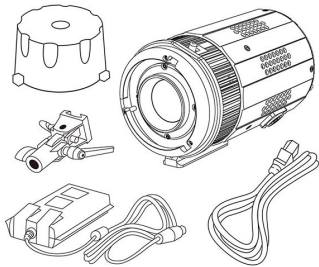

Model	Sunray 260 DT
LED Power (W)	260W
Lumen (lm)	27000lm (5700K) 22000lm (3000K)
Frequency (Hz)	20 kHz
EV/1M	8200lux / 11.7EV f7.1, 1/60s, ISO100, 5700K
CRI	98
TLCI	98
Color Temperature (K)	3000 to 5700 ± 100K
Dimmer	1~100%
Mount	Bowens S-Type
Remote	DMX (Rj45 in/out) 1~256 CH.
Fuse	8A/250V
Power Supplier	INPUT : 100~240V AC, 50/60 Hz, 4.5A INPUT : 48V, 5.84A, 280.32W MAX
Working temperature	-10° C ~ 60° C

Instructions

1. Install the joint

There are 1/4" and 3/8" screw holes at the bottom to help you mount on tripod.
Please install the light stand joint before you mount on stand.
Please shake light stand joint to ensure stability after install and prevent the LED from falling.

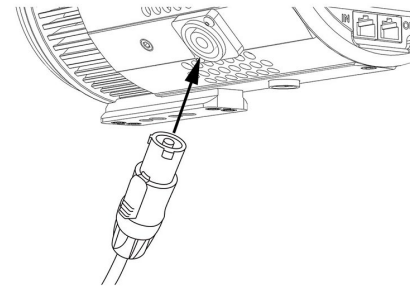
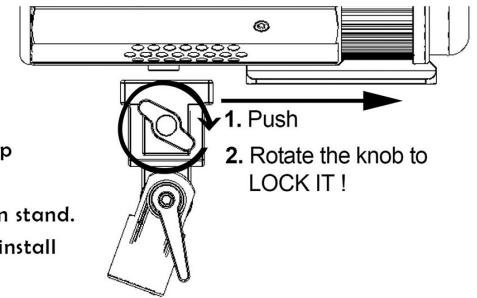

2. Connect to the power adapter

The LED can connect the power supplier or high capacity power bank KPH-4801 (optional).
Please turn off the power before connect or remove the cable.
Rotate the cable to lock position to prevent disconnection.
To remove the cable, keep pressing the buckle and rotate.

3. Panel Function Instructions

- A. Power Switch**
Mechanical power switch.
(Please connect the power cable before turn on the power.)
- B. Dimmer**
Adjust the brightness, 0~100%
- C. LCD (Dimmer)**
Brightness display with %, the degree is 1% as below :

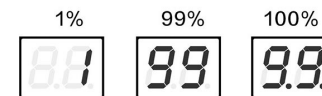

- D. Color Dimmer**
Adjust the color temperature, 3000K~5700K
- E. LCD (Color Dimmer)**
Color temperature display with numbers.
the degree is 100K as below :

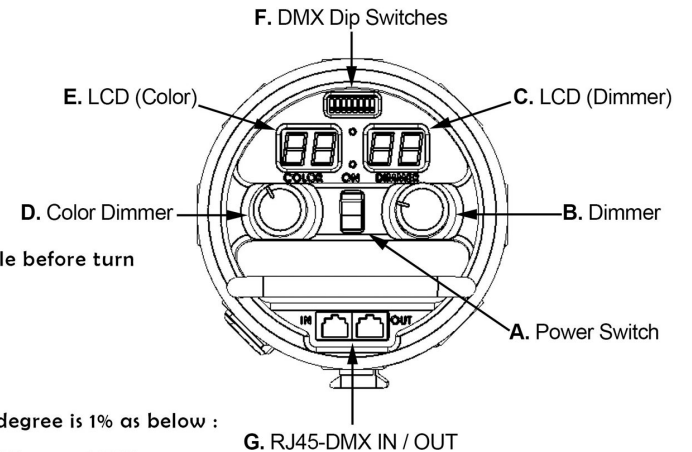

- F. DMX Dip switches**
DMX channel switch, please follow the "DMX instructions".
- G. RJ45-DMX IN/OUT**
Connect the DMX console or lamp, please follow the "DMX instructions".

4. DMX instructions

Sunray 260 DT support DMX remotecontrol system. The channel is seting by Dip switcher at the top of control panel.

There are two sockets (RJ-45) for DMX connection (at the bottom of control panel), Both can be link to the DMX controller or other DMX devices. By setting the DMX channel for each devices, you can control them from DMX controller.

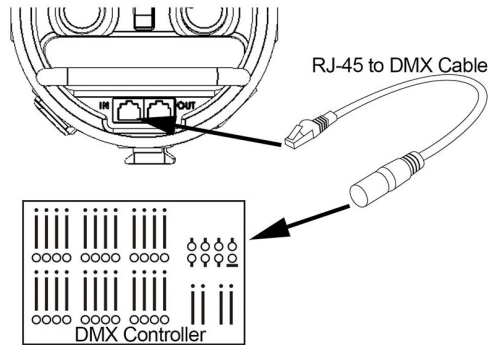

Step1. Active the DMX function

To Activate and set up the DMX when any of DMX Dip switch to ON.

After the DMX is activated, the dimmer at the control panel will lose function , LCD will display the DMX channel. (follow the step 2)

Step2. DMX channel setting

Sunray 260 DT will take 2 channels , main channel for brightness dimmer , main channel +1 for color temperature dimmer.

Channel setting range : CH1-255

Dip channel setting is binary system ,detail as below :

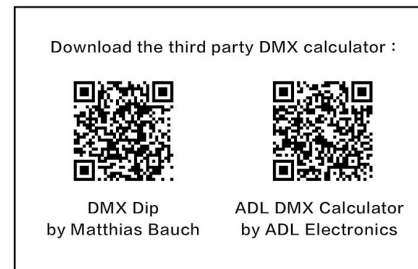
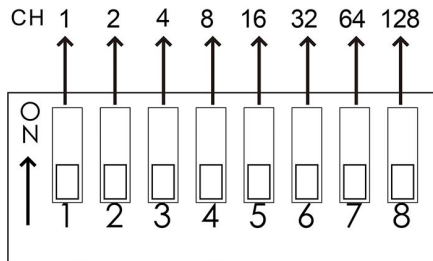

The DMX Channel setting please follow below as reference :

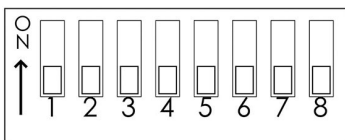

DMX OFF

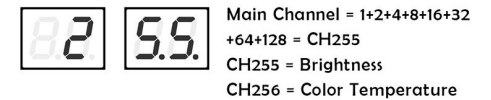
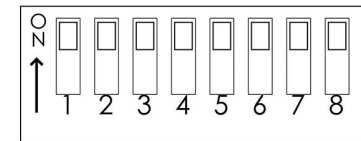
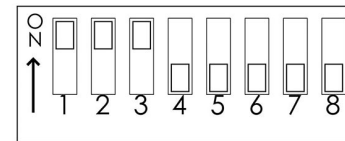
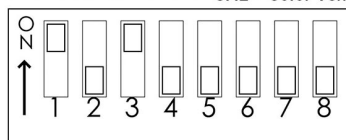
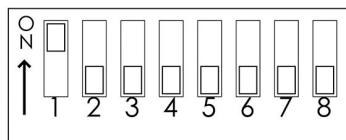
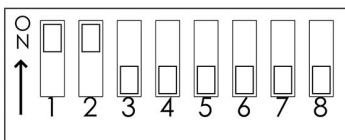

Notice

Working Environment

Do NOT using at dangerous enviroment for electronic device. Do NOT using at overheated (>60°C) and undercooling (<-10°C) enviroment.

Please using with stable and consistent power supply (100~240V AC, 50/60 Hz).

Do NOT using at enviroment with too much moisture · oil and dust.

Do NOT cover the cooling fin of led and power supplier , or using in sealed container.

Operation

The working temperature of cooling fins can reach to 60°C , please wear glove for safety

Do NOT remove the power supply cable when led power ON. Do NOT use the battery or power supplier which are not provided from Skier to avoid any damage.

Do NOT pull or trample the power supply and control cables. The LED COB with high temperature that could cause object burning , keep a distance from any object and select heat-resistant light modifiers for safety.

Transportation and Storage

Please install the protector to protect the LED COB when transport / store the led.

Please remove all the cables before storage.

Do NOT fall or shake or smash the led and power supplier.

Maintance and Clean

Keep the LED COB clean , Do Not turn on the power when any dirt on it.

Do NOT use detergent to clean the led and other accessories. Clean the COB gently by clean and dry cotton cloth with some alcohol.

Please store the led and accessories in dry and few dust enviroment.

Troubleshooting

The LED can't switch on :

Check the indicator light on adapter . If it's not showing, please check the electrical outlets is normal or not.

If the electrical outlets is normal but the adapter is not showing (or flickering), please contact us.

If the indicator light is showing , please check the fuse (8A) has blown out or not.

If the fuse has blown out very often , please check the stability of power supply and contact us.

If there has other situation , please contact us.

Auto temperature control fan fault :

The fan will adjust the rotating speed according to temperature

If the fan not working after power on , please turn off the power to avoid any damages.

If there has some noise from the fan , please check if anything stuck inside

If LCD showed fault display , please note the content and contact us.



Abnormal temperature:
Temperature detection does not work



Abnormal Fan:
Fan or rotate speed control malfunctioning.



Overheat Protection:
The LED active the overheat protection , it will auto adjust the brightness to 5%.